

- STANDARD NOTES:**
1. Parking is to be restricted 72 hours in advance, unless there is an emergency.
  2. Signs shall be installed prior to the commencement of all work, and removed immediately after completion of activities.
  3. If a sign is no longer required it will be removed or covered.
  4. Signs must be FHWA Approved / NCHRP - 350 Rated.
  5. Signs shall be mounted on spring-loaded sign stands or devices that meet current crash test rating approval as indicated in the current MUTCD or by current FHWA Standards.
  6. Work Zones must adhere to the "Guidelines and Standards for Temporary Traffic Control" issued by the Federal Highway Administration (FHWA).

**SIGN SPACING GUIDE**

SPEED (mph)	MIN. SIGN SPACING (ft)
25	150
30	200
35	250
40	350
45	550
50	600
55	700

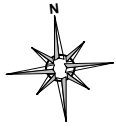

**Legend**

- Arrowboard (Single)
- Barrier
- Cone
- Crane inside WkZn
- semi trailer in WkZn
- Sign Stand
- W20-1 road work ahead
- Work Area

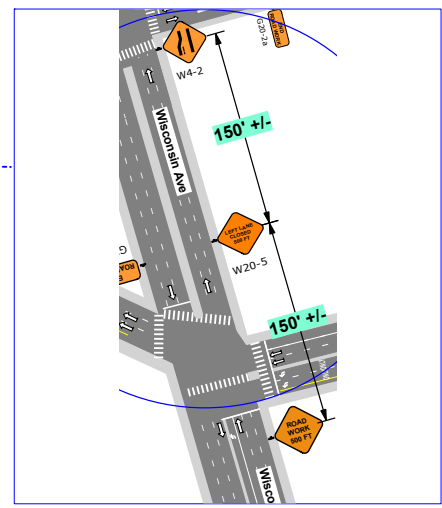

Traffic Control Plan

Site Address: 7750 blk Wisconsin Ave. Bethesda, MD

Drawing not to scale

Comments: Working from the west curb of Wisconsin Ave between Middleton Ln & Norfolk Ave.